

# Balcony Greenhouse 'CB213'

Assembly instructions

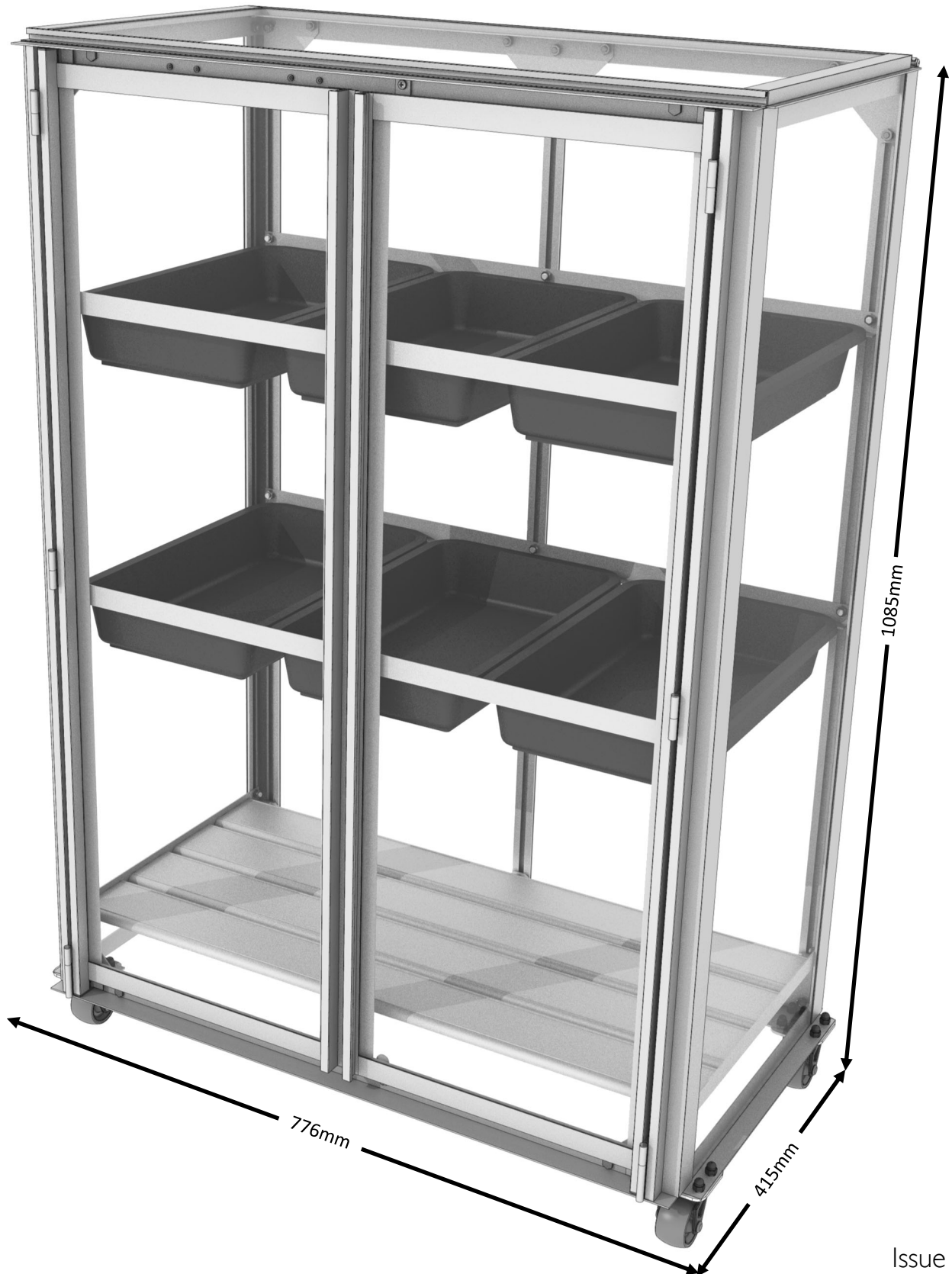

**GB** Thank you for purchasing your new Balcony greenhouse. We recommend you familiarise yourself with the instructions and read all safety information before you commence assembly.

These instructions are divided into sections; **Glass list, Rear, Front, Sides, Doors, Vent, Wheels, Staging, Seed trays.**

If you need to contact us for assistance please refer to the relevant section/s.

### **Safety Warning**

- Glass and aluminium can potentially cause injury. Please ensure you wear protective goggles and gloves during assembly.
- Please remember that glass is fragile and should be handled with extreme care. Always clear up and dispose of any breakages immediately.
- Do not assemble in high winds.

### **Site Preparation**

- When selecting a site for your Balcony greenhouse, it is **vital** that you choose as flat and level an area as possible.
- To minimise the risk of wind damage, try to select as sheltered a site as possible.

### **Additional Considerations**

- Please bear in mind that assembling your greenhouse can be time consuming. You may need to spread the construction over more than one day.
- You will find it helpful to prepare a large, level, clean and clear area in which to work in. A garage floor is ideal. Put down some cardboard or a sheet to protect the paintwork from scratching.
- Most parts are numbered and can be identified by a removable label. Alternatively, the components can be identified by the shape of their end profiles and the lengths detailed in the parts tables.



# Glass 'CB213'

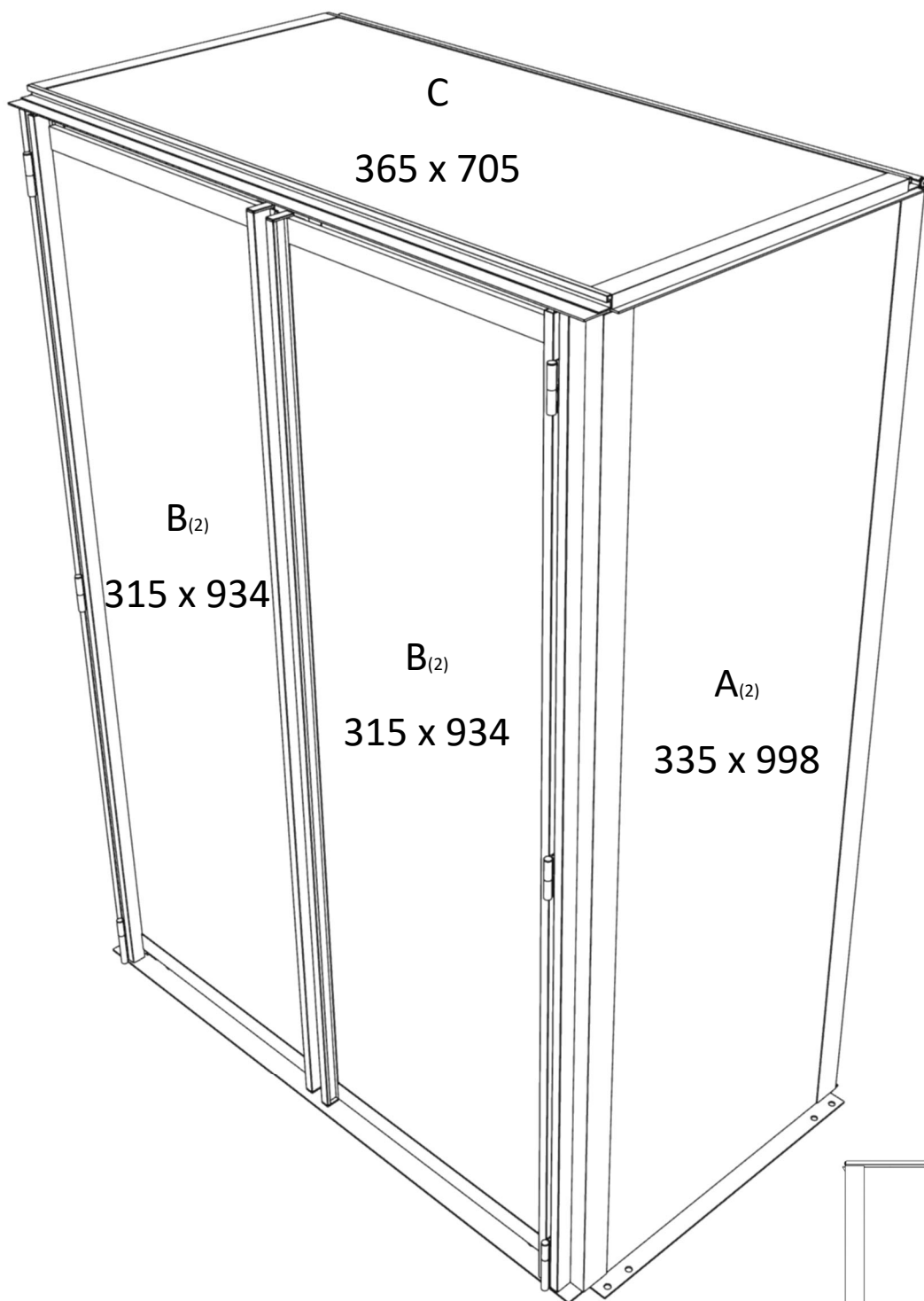

Rear View

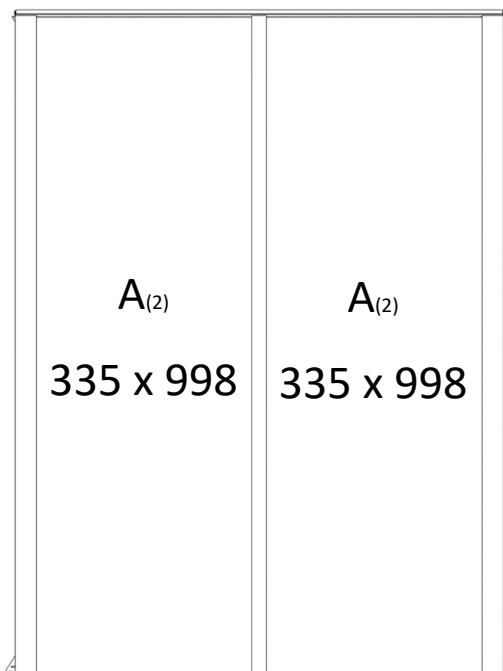

CB213 Balcony Greenhouse		
Glass pane	Size in 3mm toughened	Quantity
A(2)	335 x 998	4
B(2)	315 x 934	2
C	365 x 705	1

**Before you begin....**

Your Balcony Greenhouse is assembled by sliding the heads of hexagonal bolts 'a1' into channels which then allow other parts to join together or by sliding in square 'a23' nuts, see below. Later on in construction you will also use some twist-in crop headed bolts which allow retrospective attachment, details shown later.

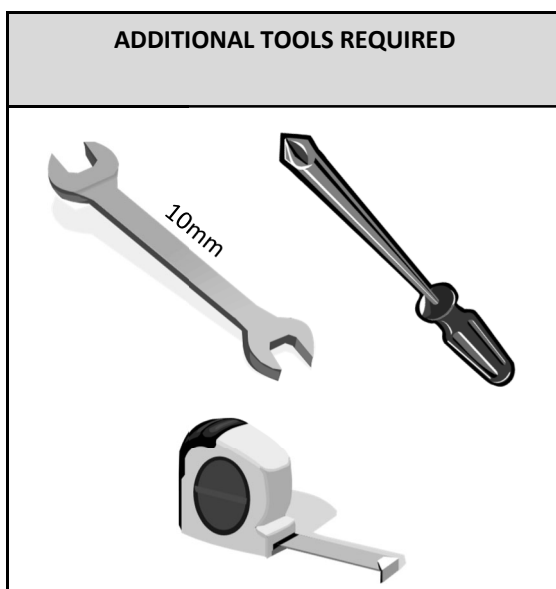
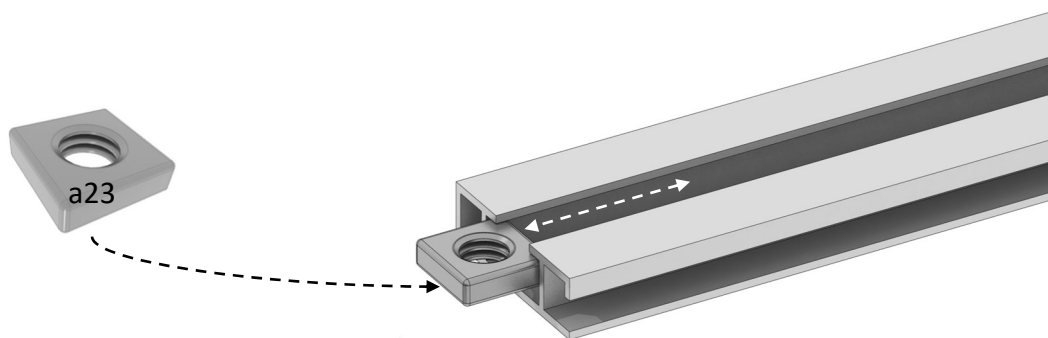
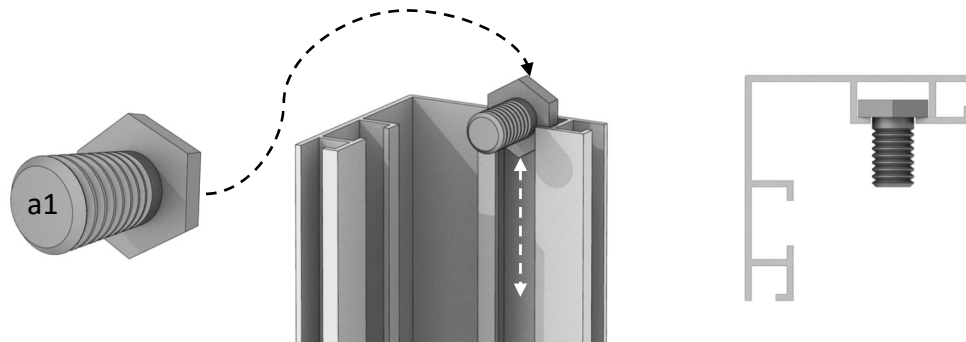

KEY SYMBOL	MANUAL KEY DESCRIPTION
	EXTERNAL VIEW
	INTERNAL VIEW
	CORRECT / COMPLETE
	TWIST TO LOCK

Rear	Image											
	Part Code	8402	8304	8305	8405	8300	8400	a1	a2	a16	L	R
	Length(mm)	1000	736	736	1000	n/a	n/a	M6x10	M6	n/a	n/a	n/a
	Quantity	2	1	1	1	4	2	20	20	6	1	1

**1st** Start your build by laying out the parts below on the ground and begin to assemble the rear frame of your greenhouse.

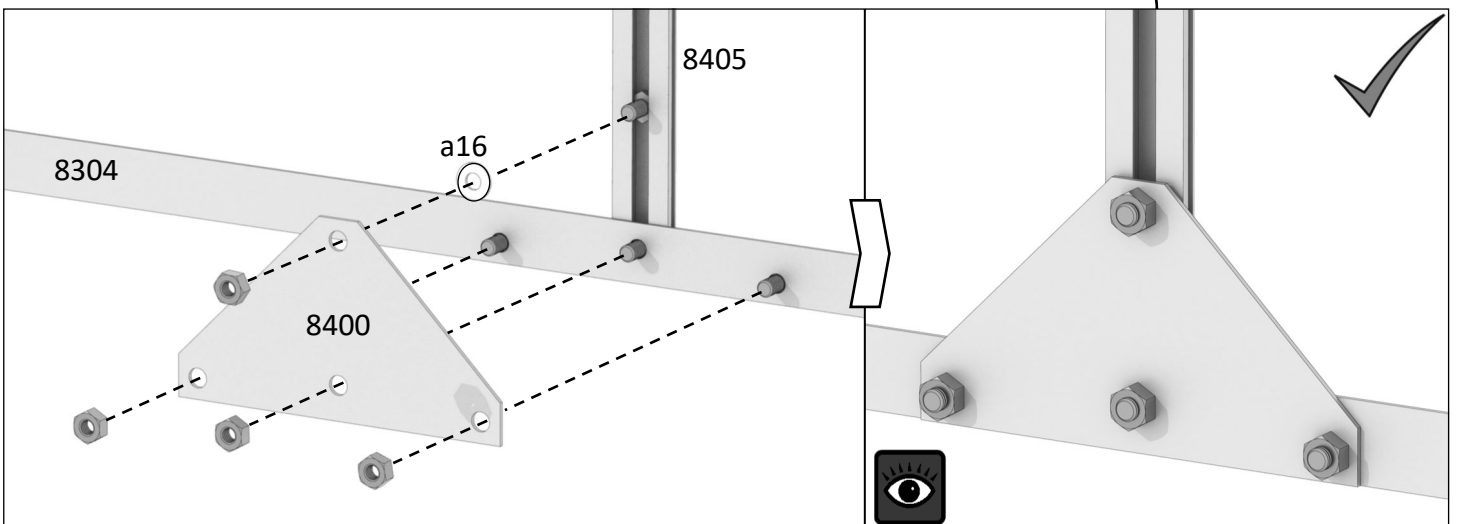
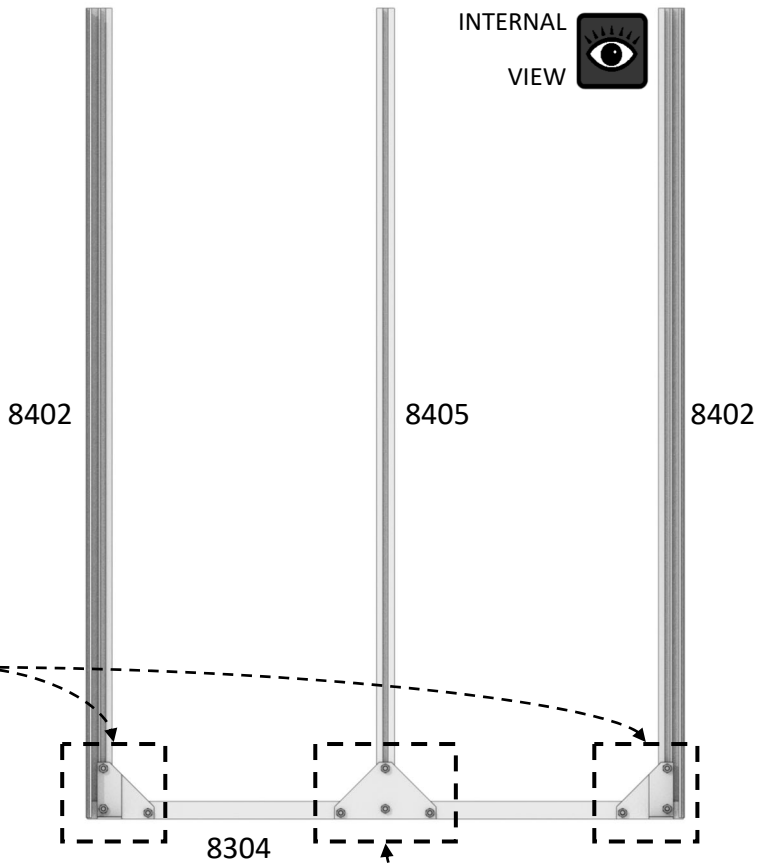
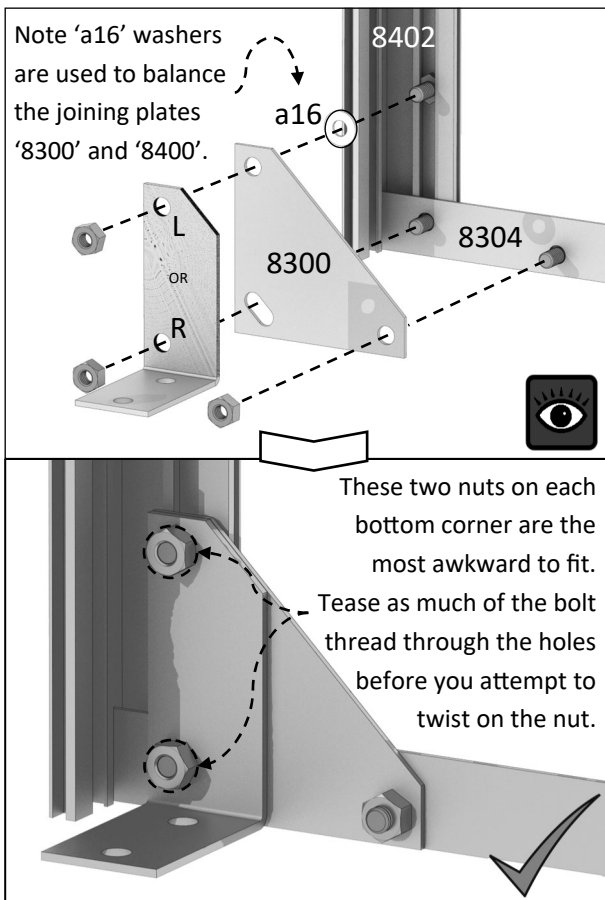

**2nd** Now that you have attached your rear verticals to the rear cill you can carefully slide the 335mm x 998mm glass into the frames glass channels, see aerial view below.

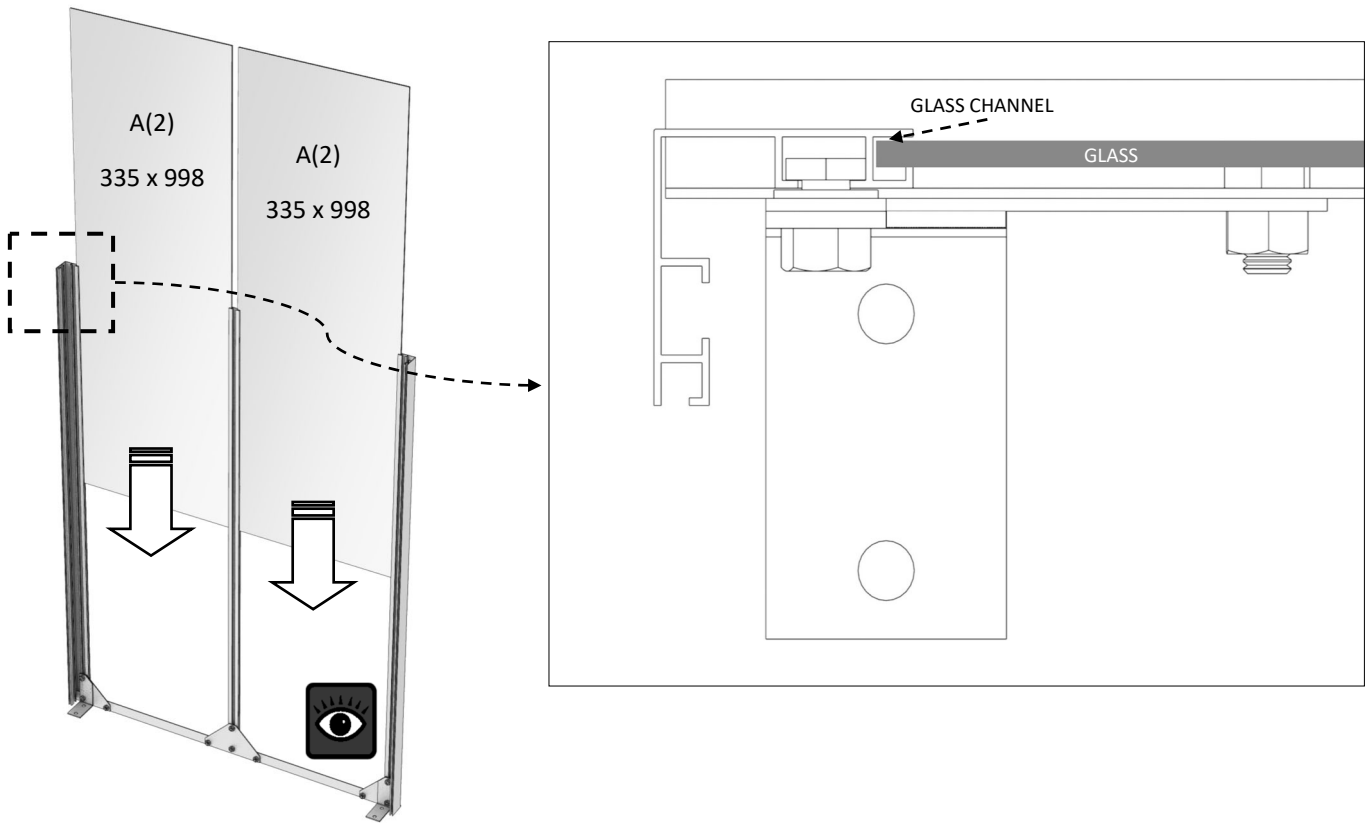

**3rd** The rear top angle '8305' can now be added in a similar way to the rear bottom angle you attached earlier.

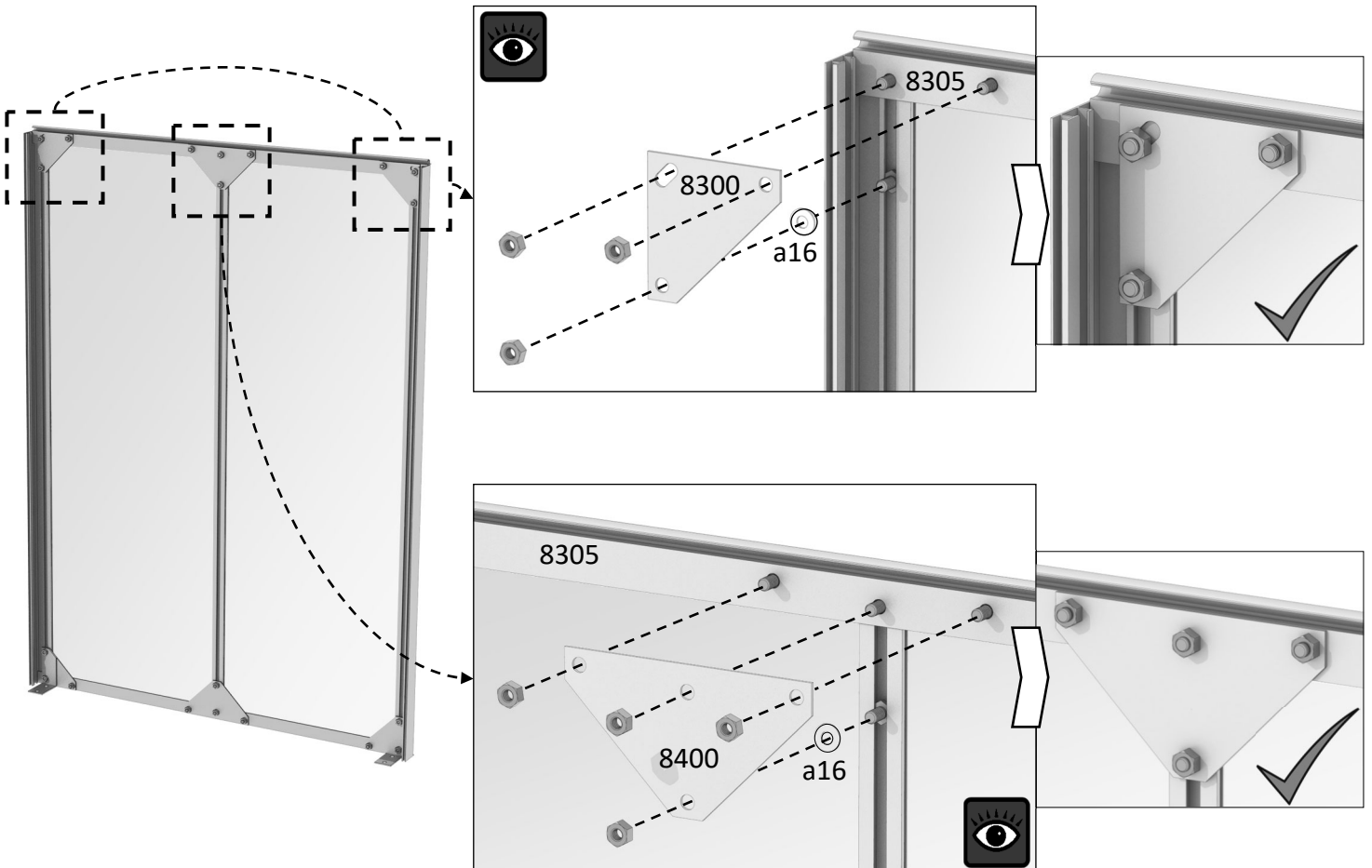

# Front (part 1)

Image						
Part Code	8408	8430	8431	a32	a23	Hex Key
Length(mm)	1000	40	20	M6x6	M6	n/a
Quantity	2	2	4	8	8	1

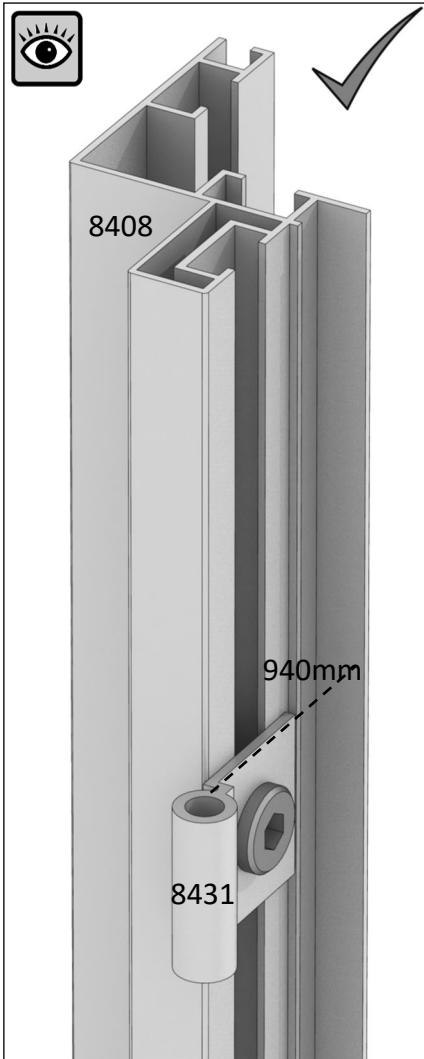
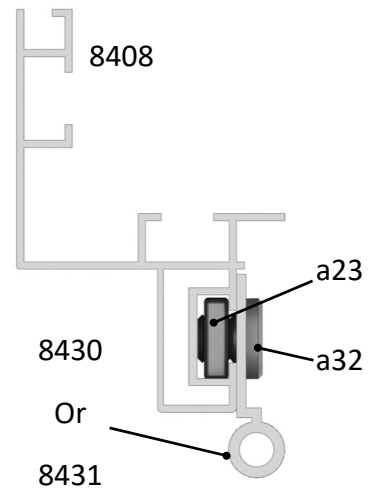

Before you can assemble the front section you need to accurately position the door hinges '8430' and '8431' into the front corners '8408', see mm measurements to the right. Orientate and position the brackets accurately to create two mirrored front corner assemblies. Use the Hex Key provided to tighten the a32 bolts into the square a23 nuts. The a23's slide into the 8408's from either end. The 8430's should be flush with the bottom of each mirrored 8408.

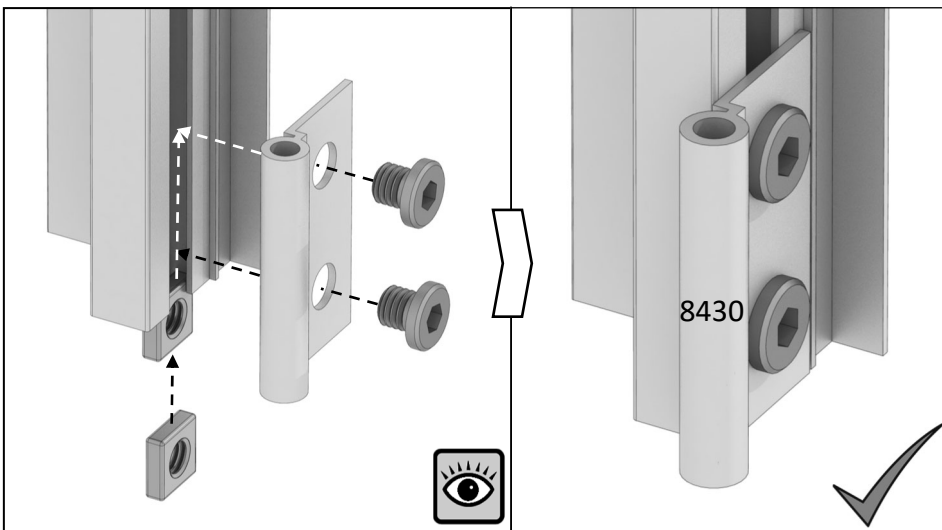
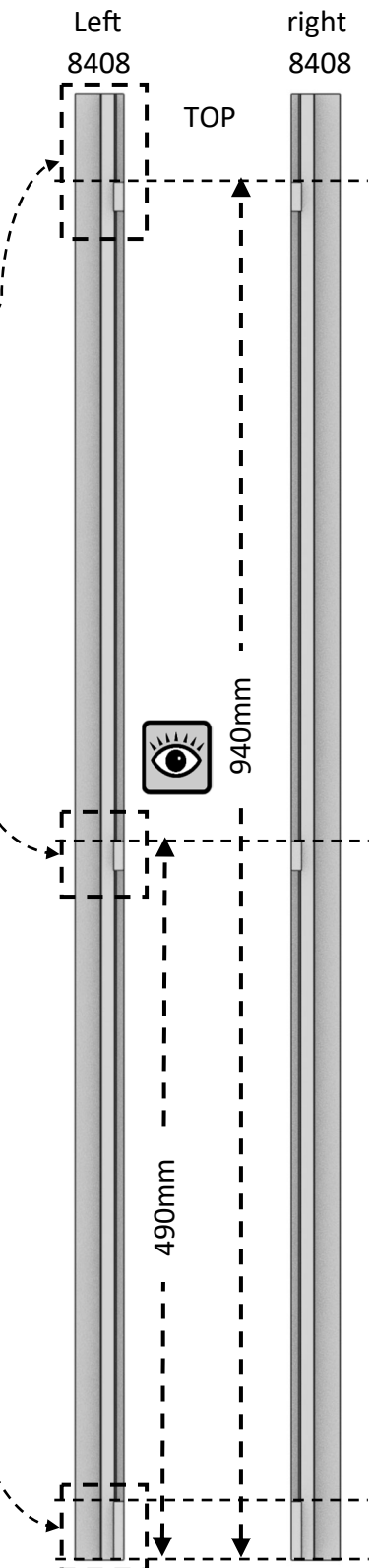
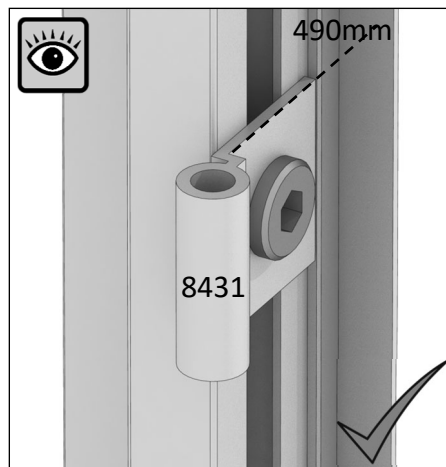

Front (part 2)	Image											
	Part Code	8315	8316	8300	m11	a1	a2	a7	a10	a16	L	R
	Length(mm)	736	736	n/a	n/a	M6x10	M6	M4x8	M4	n/a	n/a	n/a
	Quantity	1	1	4	2	12	12	2	2	6	1	1

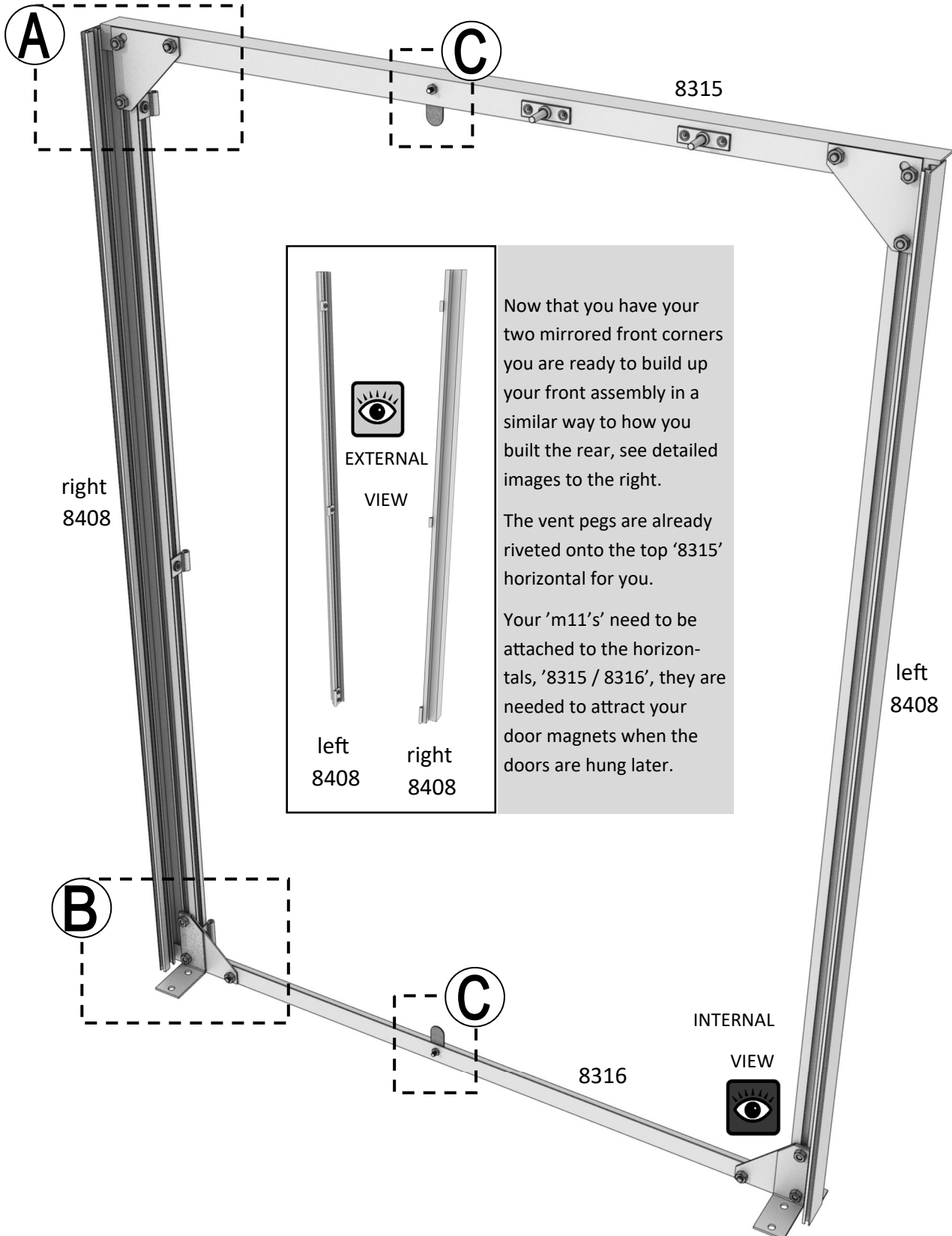

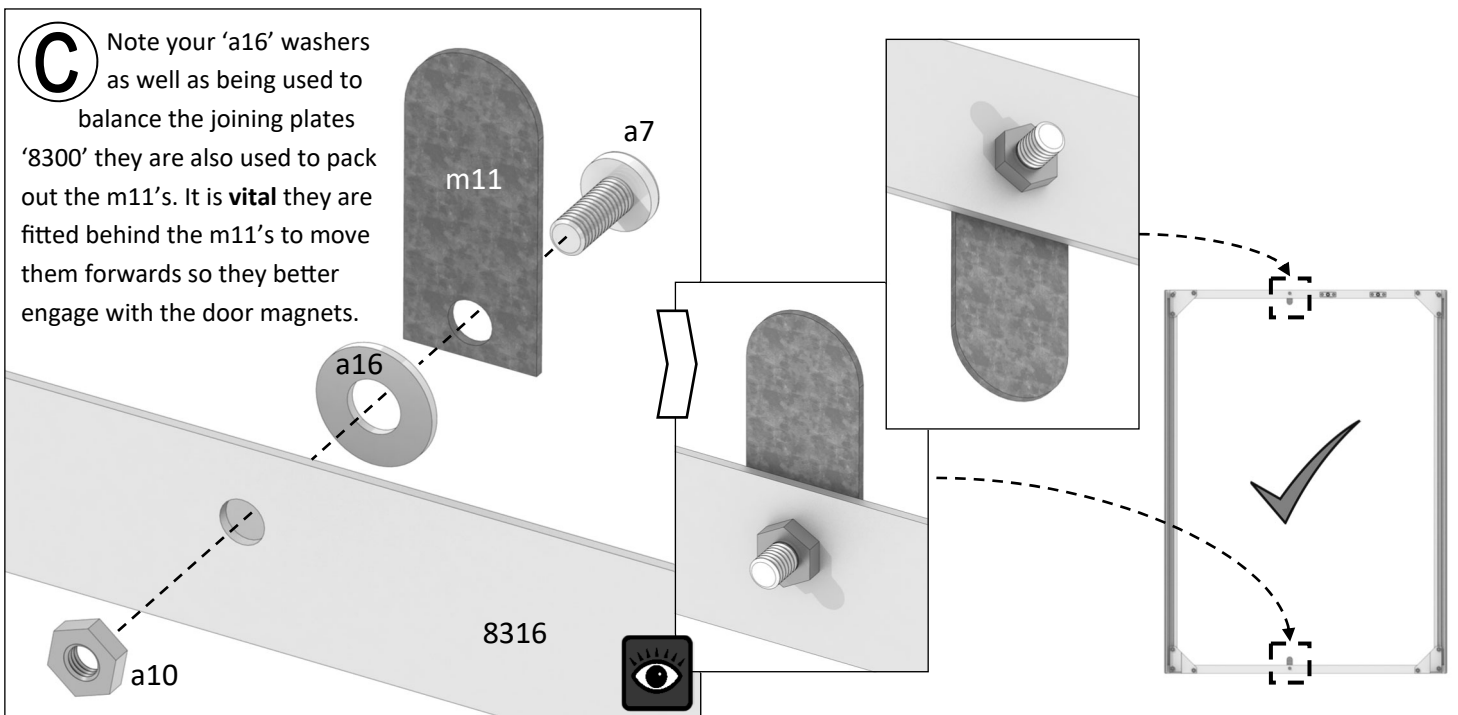
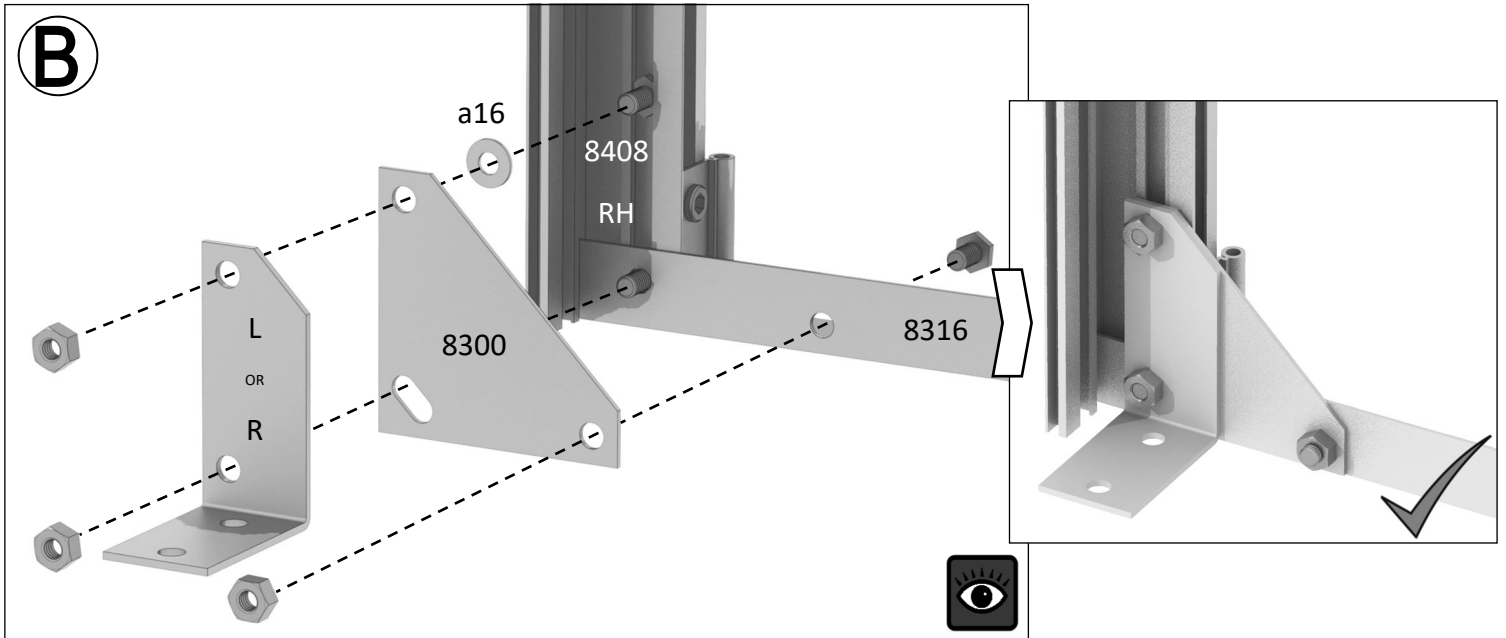
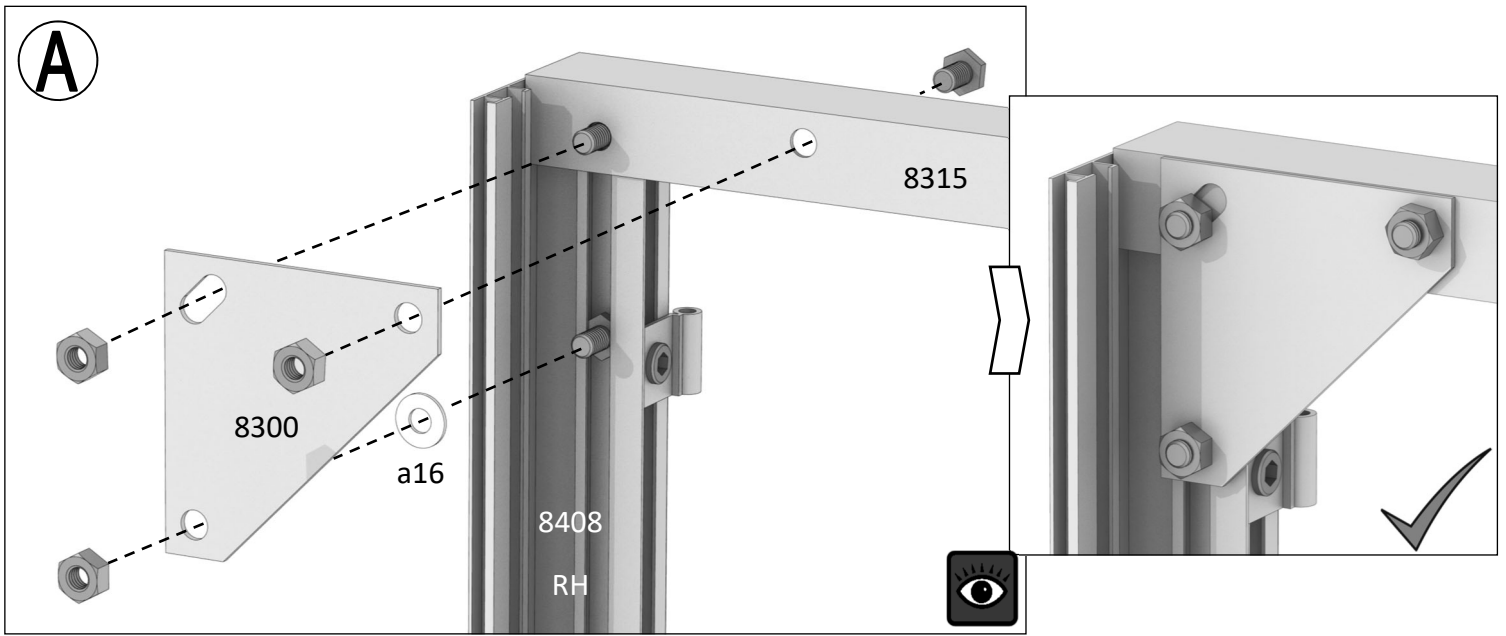

# Sides

Image				
Part Code	8410	8411	a1	a2
Length(mm)	372	372	M6x10	M6
Quantity	2	2	8	8

Now that you have your built the rear and the front frames you are ready to build up the sides in situ to connect them.

Start by loosely fitting two nuts and bolts into each of the top '8410' and '8411' rails keeping the nuts towards the inside, see below. At this stage you will need someone to help you or somewhere stable to lean the rear section against. Attach the bottom rails '8411' first to the rear section by sliding the loose bolt heads into the rear corners being careful it doesn't fall forwards. Now that the bottom rails are attached to the rear it will be more stable than before but you still need to be careful it does not fall forwards.

You can now attach the front section to the remaining loose bolts in the bottom rails and tighten making sure both front and rear are still supported.

1st

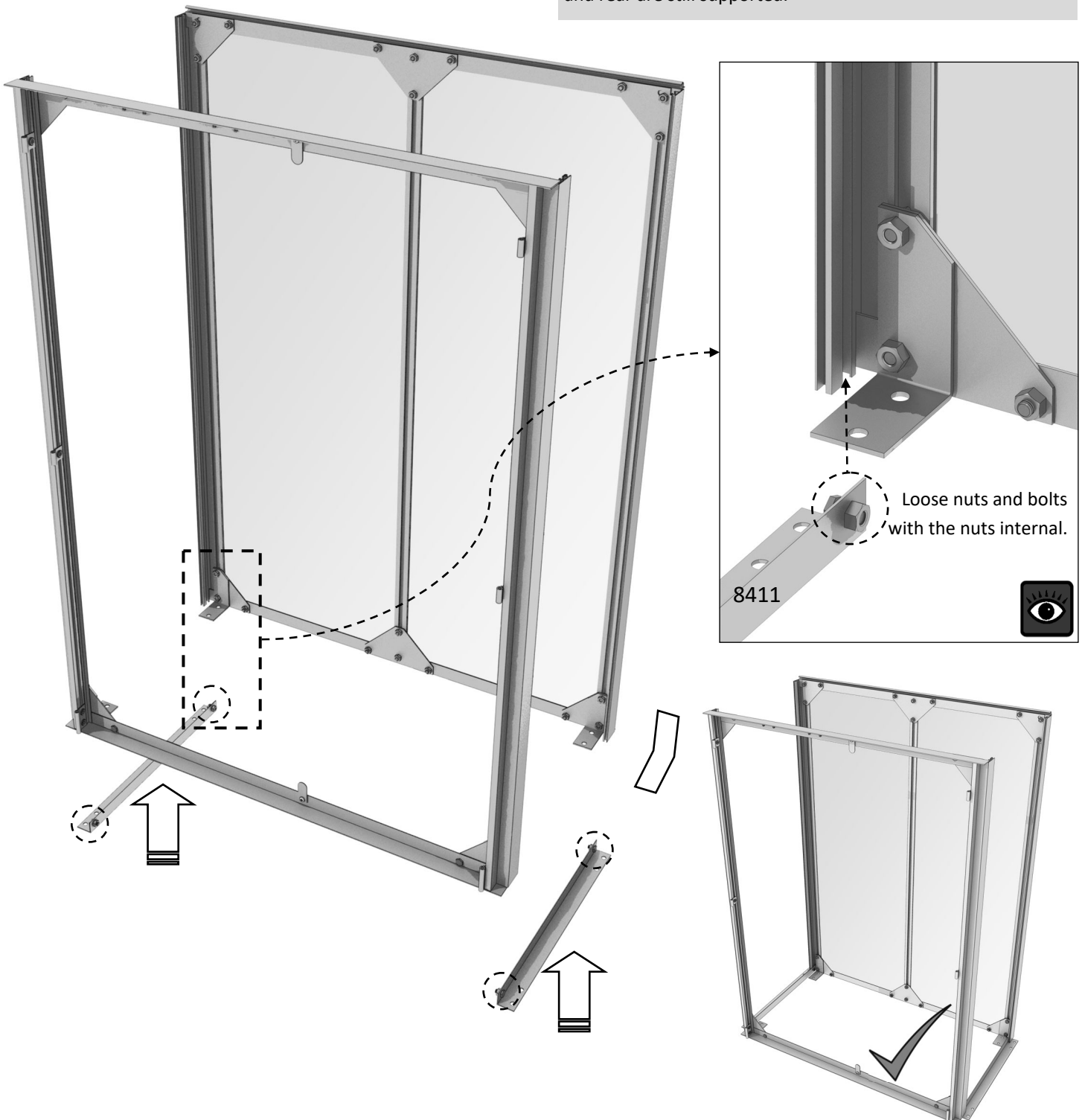

2nd

Glass panes 335mm x 998mm can now be slid downwards vertically into the front and rear corner glass channels in a similar way to how the rear was glazed.



3rd

You can now slide the heads of the loose bolts through the top rails '8410' into the front and rear corners to cap the top of the side panes and to stabilize the frame.

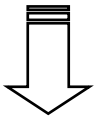

8410

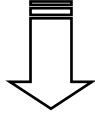

8410

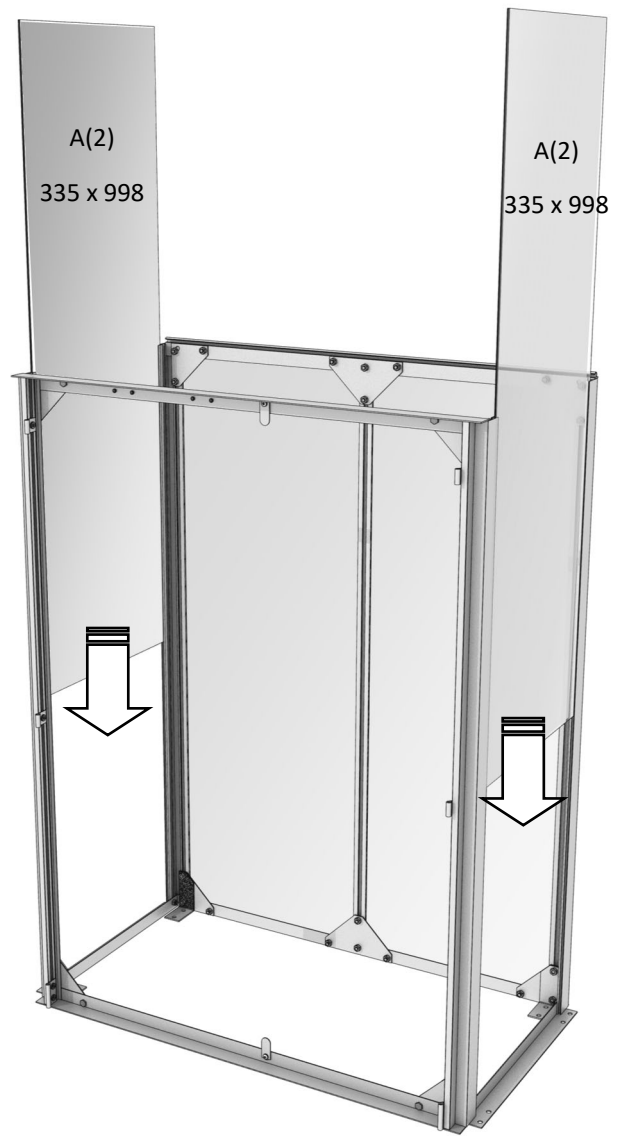

# Doors

Image								
Part Code	8413	8416	8418	a32	a23	Magnet	h8	p15
Length(mm)	994	970	309	M6x6	M6	n/a	n/a	n/a
Quantity	2	2	4	8	8	2	6	4

**1st** Your door hinges have already been riveted onto the two outer door stiles '8413' for you already. Lay both of the '8413' on the ground so they mirror one another with the flat face uppermost. Layout the door horizontals '8418' so that the glass channel faces the correct direction, downwards for the top and upwards for the bottom. Slide an 'a23' square nut into each of the '8418's' and then use the 'a32' bolts to secure the outer door stiles and the horizontals together. You can now slide the door glass 315mm x 934mm panes in laterally into the glass channels of both doors.

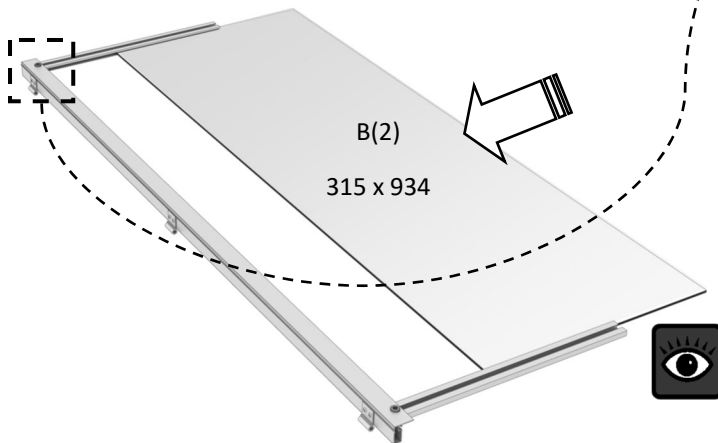
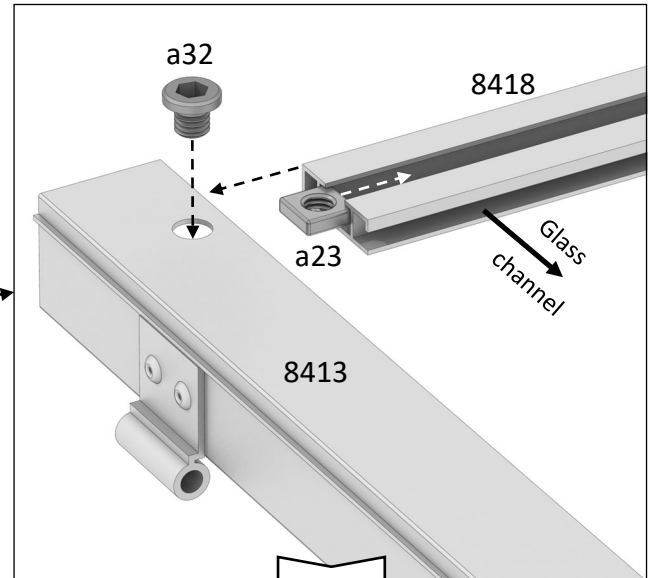

**2nd** Your inner door stiles '8416' are also both the same but on your right door, internally viewed on the left below, you need to add a magnet in the top and bottom horizontals, see right. Once the '8416' stile has been attached slide the magnet across so that it sticks to the side of the a23 nut. The other door does not need magnets, its inner door stile is held in position when the doors are shut behind the inner stile of the other magnet laden door.

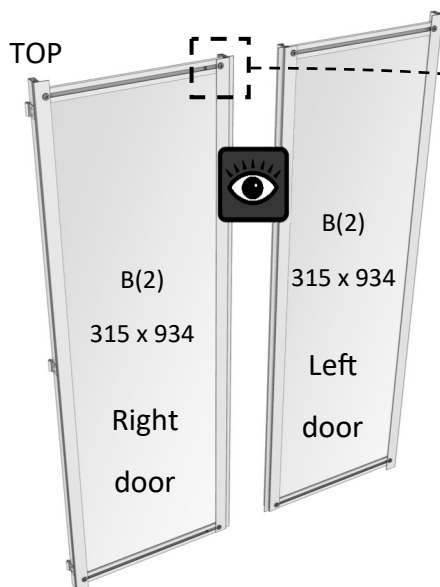
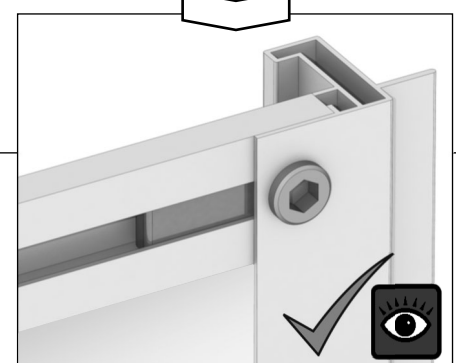
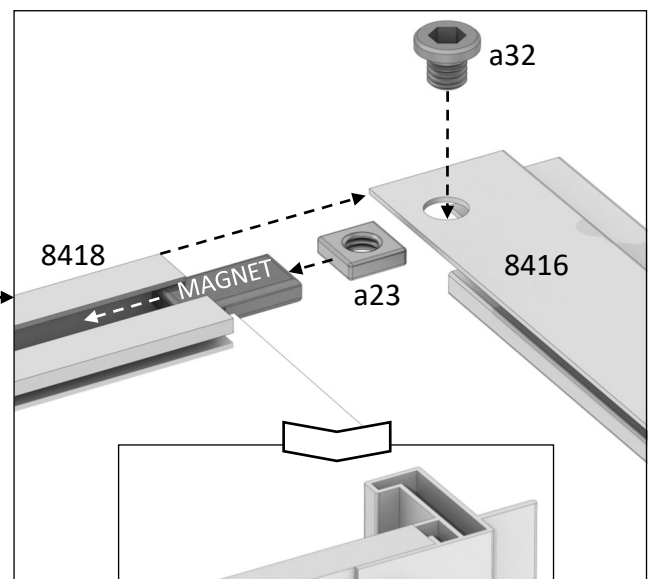

**3rd**

Now that your doors have been assembled they can be hung onto the front assembly. Position the appropriate door, left and right, and secure them by sliding down the pivot pins 'h8' x 3 per door into the '8430 / 8431' brackets previously inserted at specific heights into your front corners.

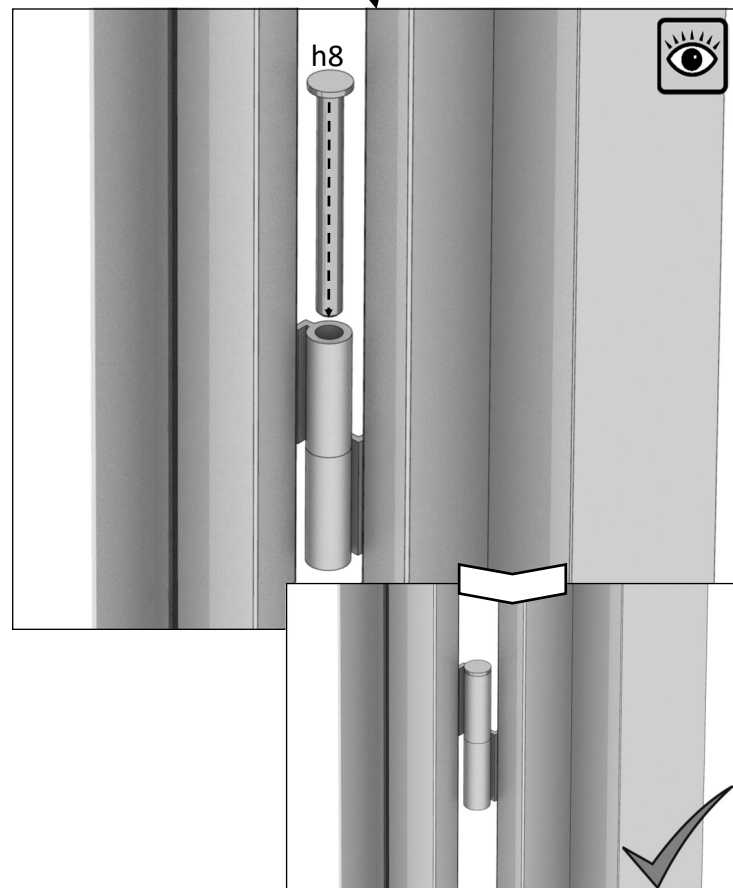
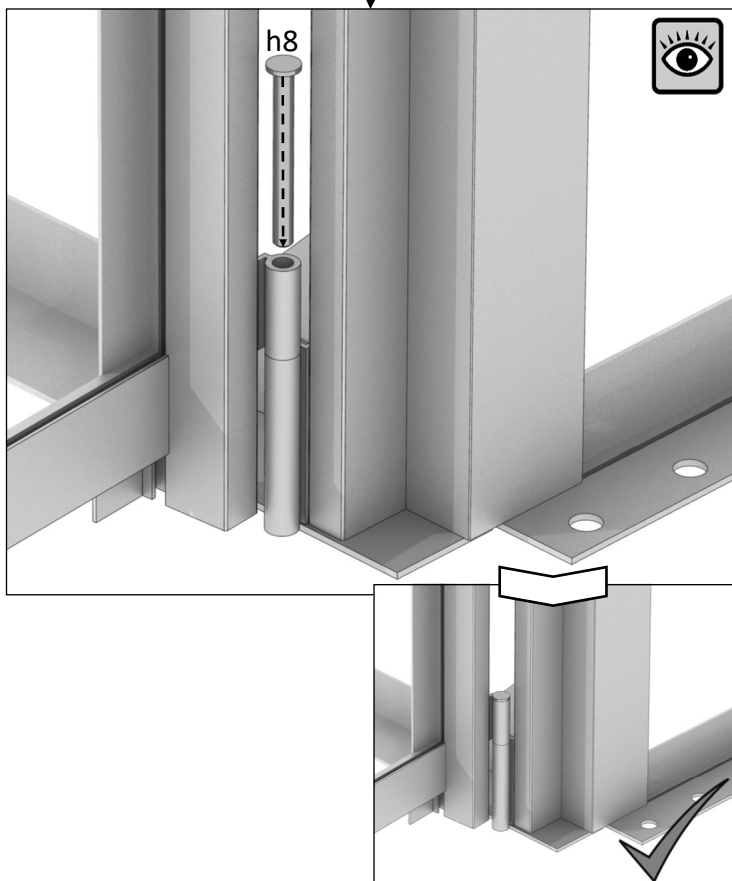
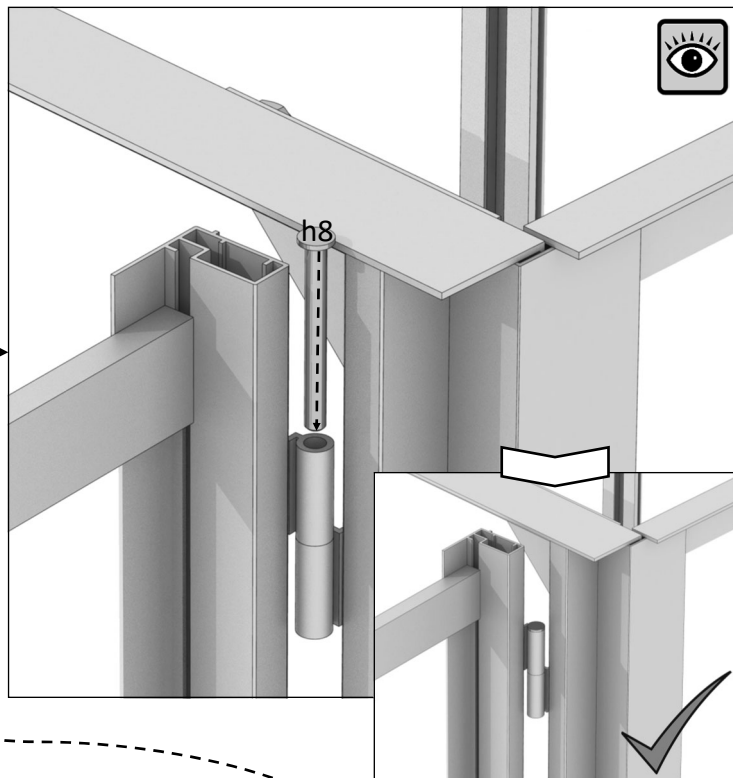
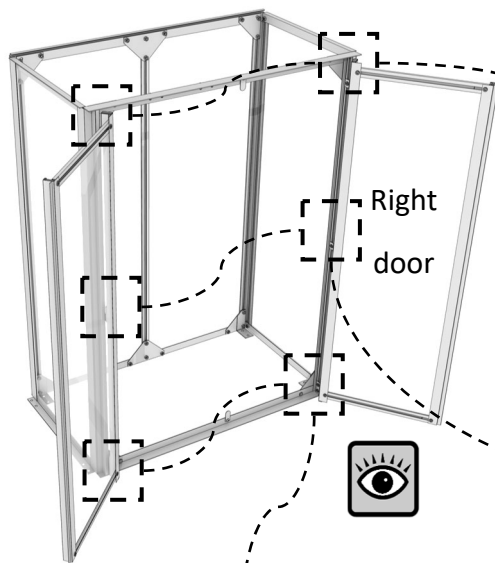

**4th**

To finish off the top face of the doors insert two 'p15' bungs per door to cap the top of all four of your door stiles.

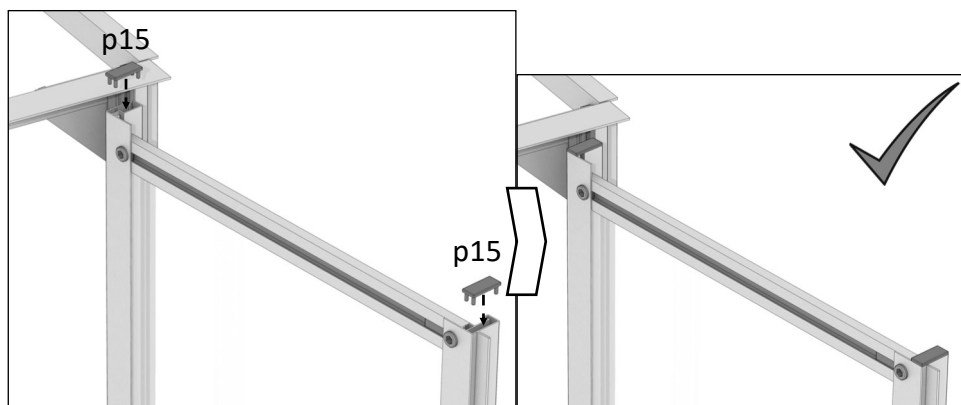

<b>Vent</b>	Image									
	Part Code	8420	8421	8422	8081	a32	a23	a12	a7	a10
	Length(mm)	737	358	737	260	M6x6	M6	4.2 dia x 9.5	M4x8	M4
	Quantity	1	2	1	1	4	4	2	2	2

**1st** Your vent is built in a similar way to one of your doors. Start with your vent sides '8421' and slide one square nut 'a23' into the channel on each one. You can then use two 'a32' bolts to join the sides to the hinge top '8420' ensuring they butt up hard to it and that the glass channels are facing inwards.

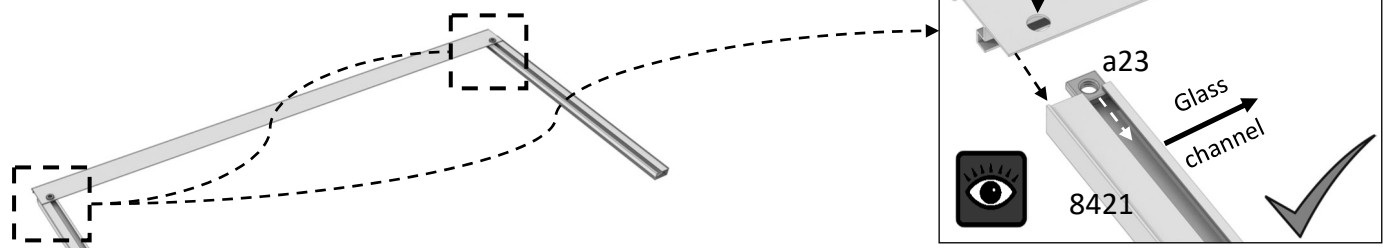

**2nd** You can now slide in your vent pane glass, 365mm x 705mm.

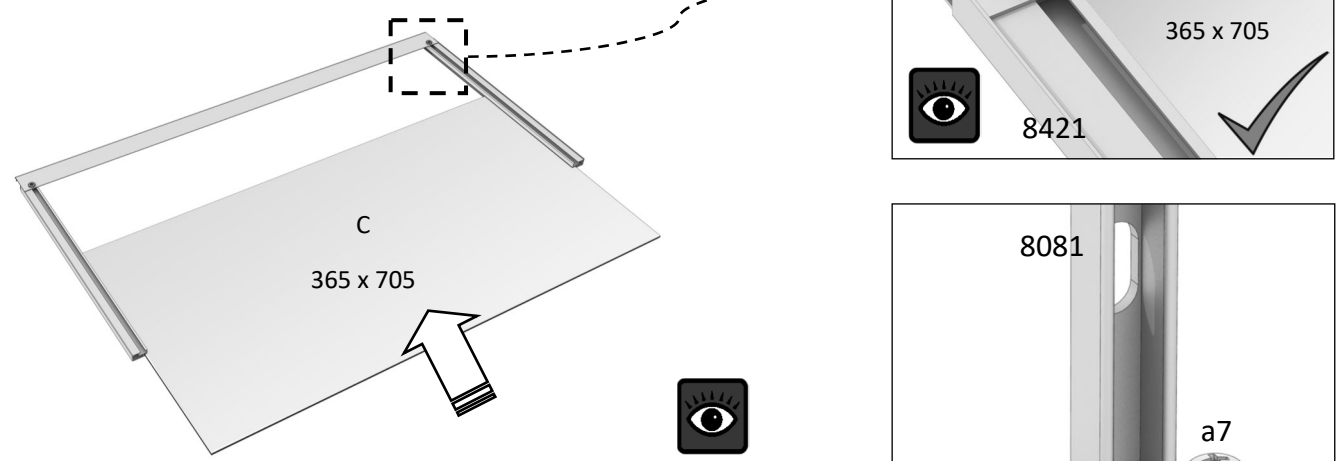

**3rd** Before you attach the vent bottom '8422' you need to attach the vent stay '8081' using two 'a7's and two 'a10's'. The stay attaches to what will be the flat lower bottom face of '8422'.

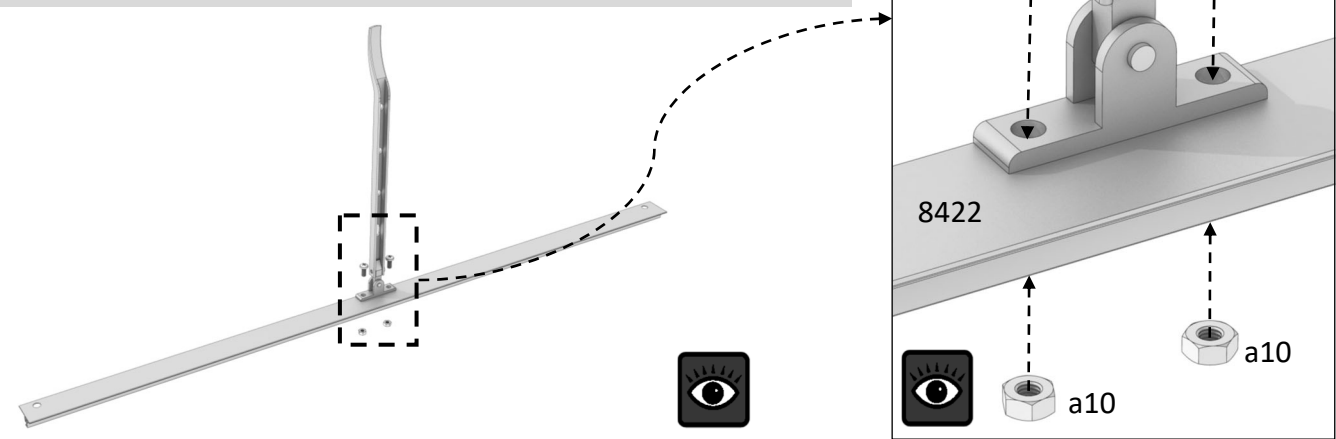

**4th** You can now attach the vent bottom assembly. In order to help keep any water out of the finished product it is a good idea to run some transparent all-weather silicone (not supplied) around the glass edges on the underside, see below.

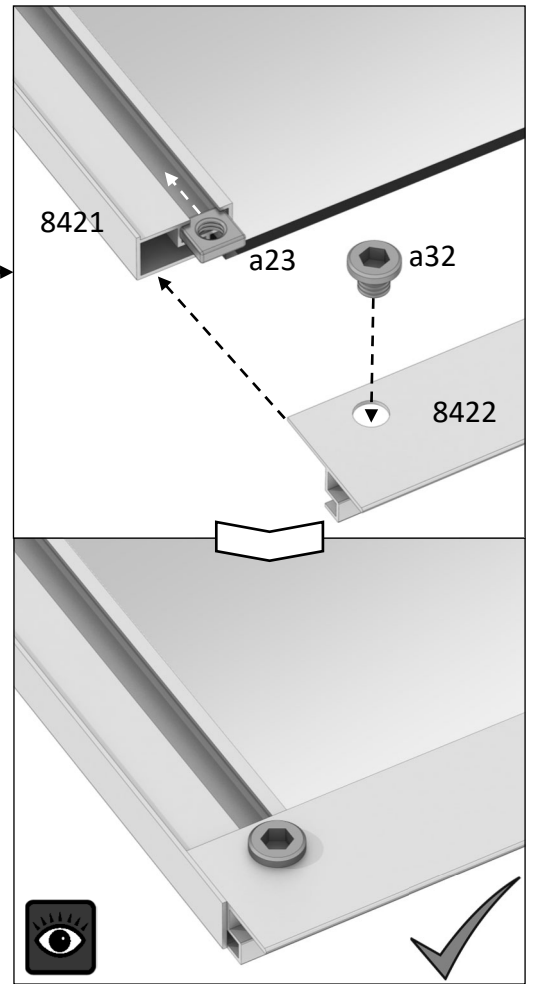
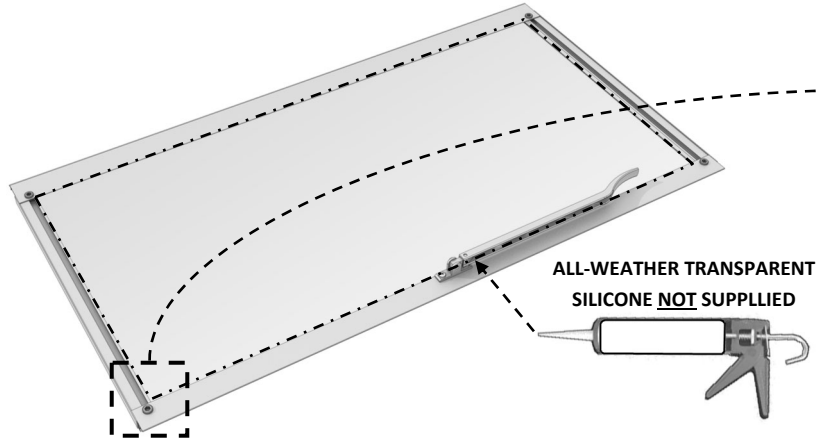

**5th** The glazed vent can now be slid into the top rail of your rear frame '8305' from one end. The vent top will pivot inside the rear rail.

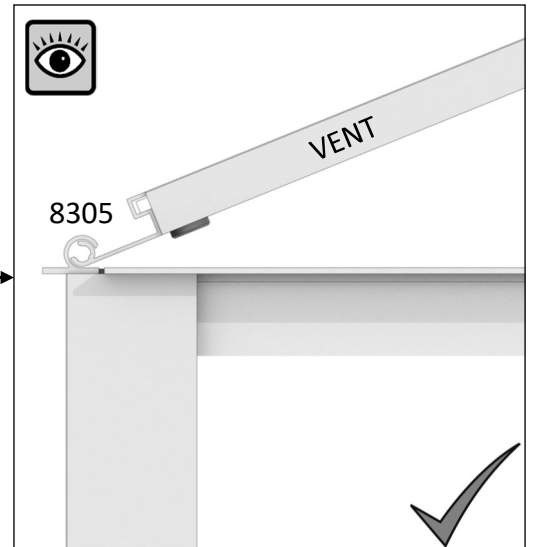
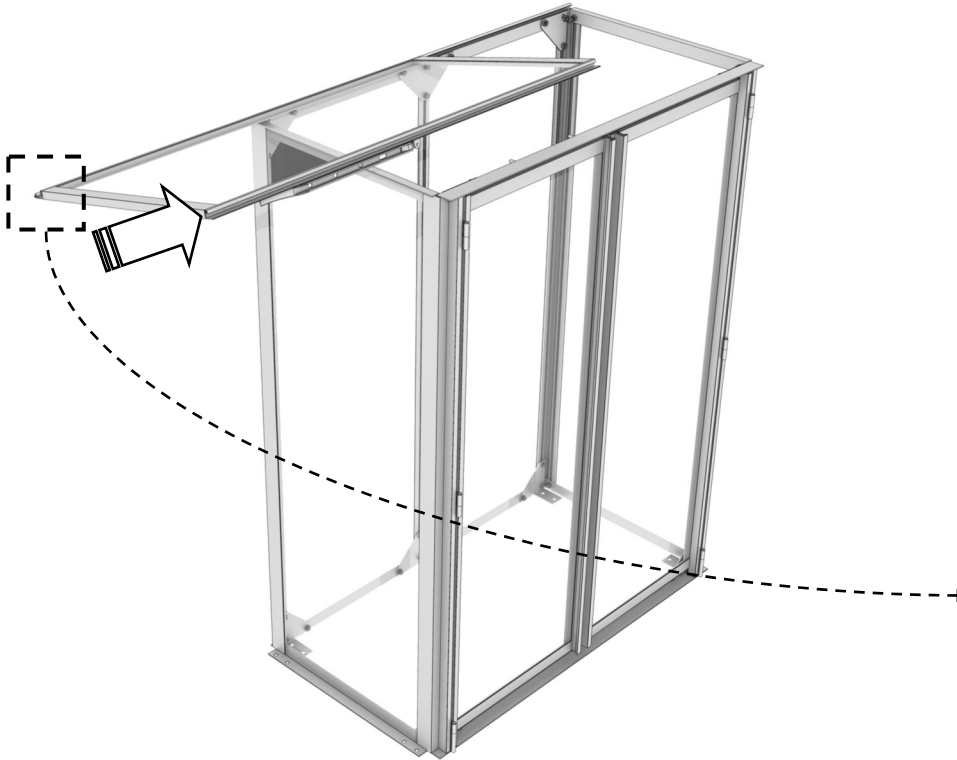

**6th** Once centralized add a self-tapping screw 'a12' to each end of '8305' to secure the vent from sliding back out.

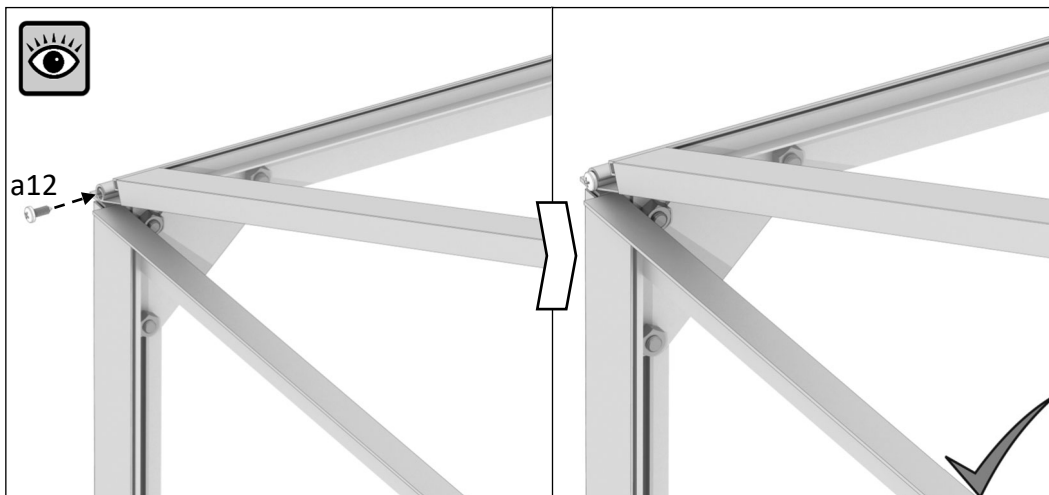



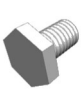

# Wheels

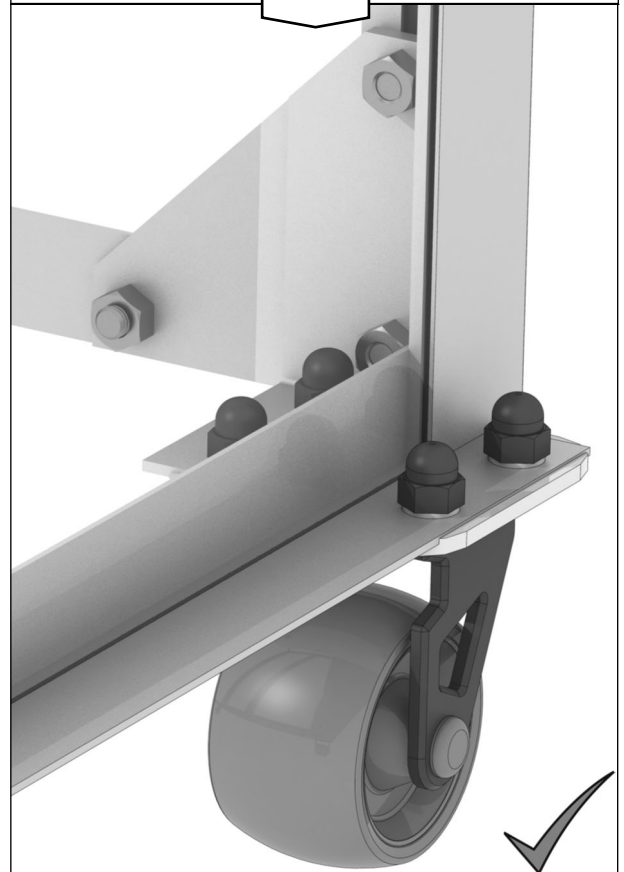
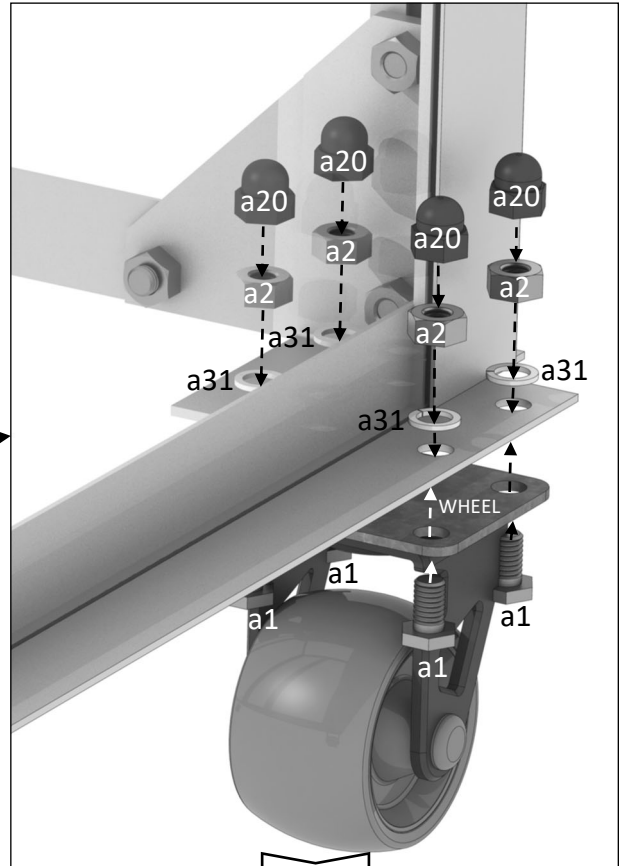
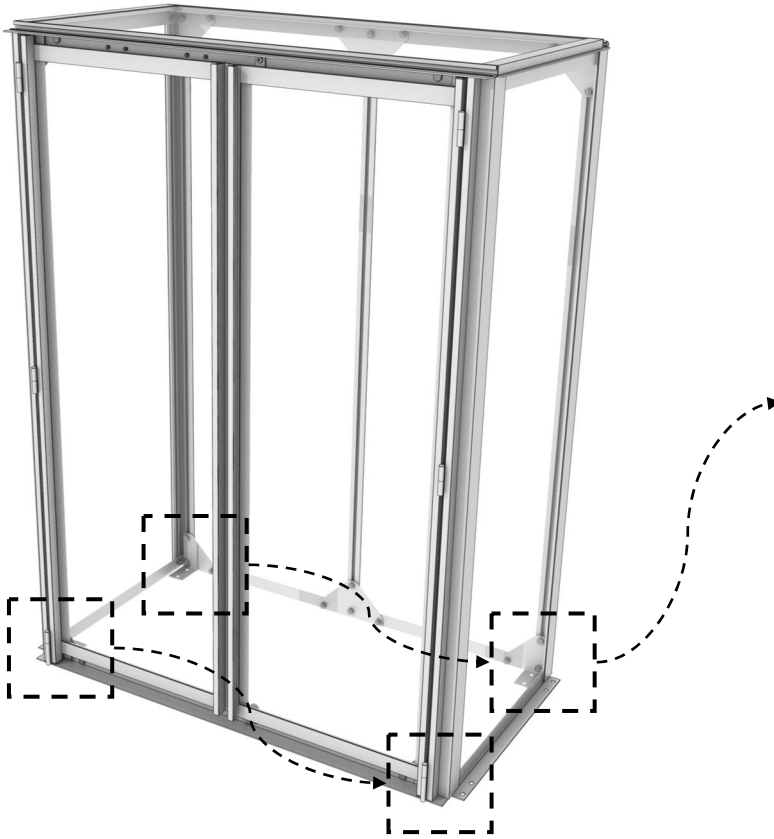
Image					
Part Code	Wheel	a1	a2	a31	a20
Length(mm)	n/a	M6x10	M6	n/a	n/a
Quantity	2+2	16	16	16	16

You can now add your wheels, see example below. Two of the wheels have brakes on them which are best fitted to the front of the unit. Please note the style of the wheels may vary from the images below. You may wish to carefully lean your frame over onto its back carefully opening the lid so it rests on the floor. The bottom will then be more accessible for wheel attachment and for the next stage when you want to add in your staging slats '8343'.

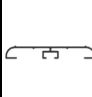

# Staging

Image					
Part Code	8342	8343	a1	a2	a9
Length(mm)	362	720	M6x10	M6	M6x10
Quantity	2	4	8	12	4

Your staging horizontal support angles '8342' are attached between your rear and front corners using twist-in rectangular crop headed bolts 'a9' and 'a2' nuts. It is easiest to put these loosely through the holes initially before you measure and set them at a height of your choosing. The lower the angles the better where the reduced center of gravity will make it more stable. The crop headed bolts can be pushed through the bolt slot face on to allow retrospective attachment, they then need to be twisted in the bolt channel to lock and are fixed by tightening the nuts.

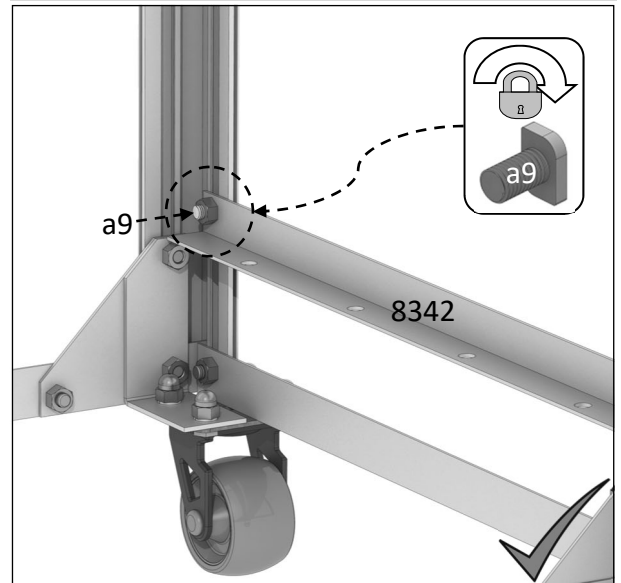
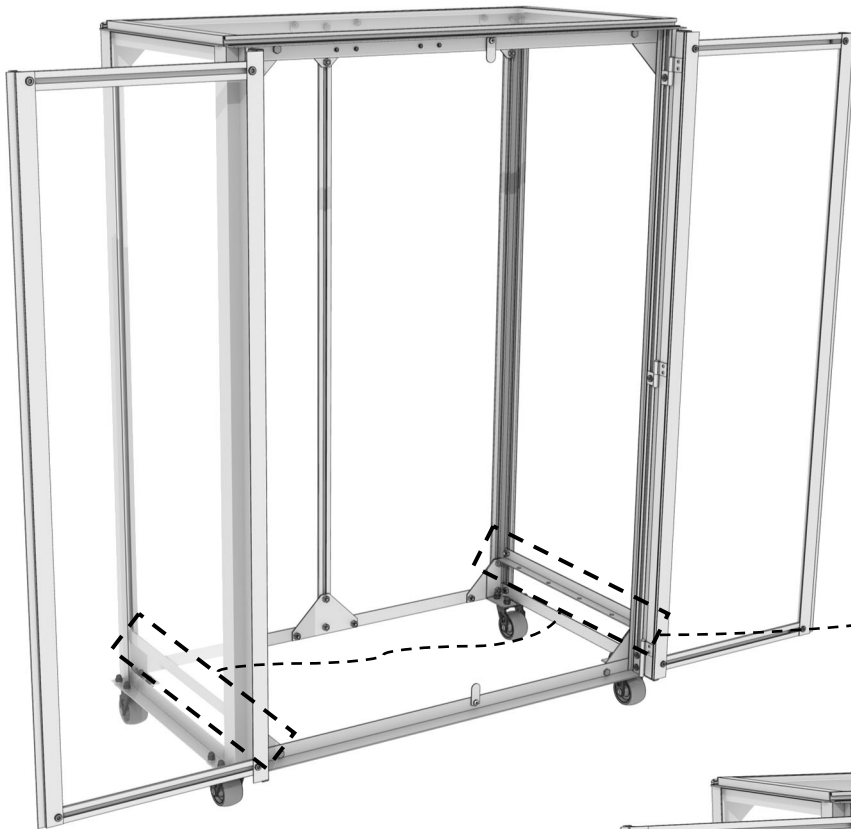

Your staging slats '8343' are attached between your staging horizontals '8342' using 'a1' hex bolts and 'a2' nuts at each end. Slide the head of the bolt into the bolt channel on the underside of the slat, see below.

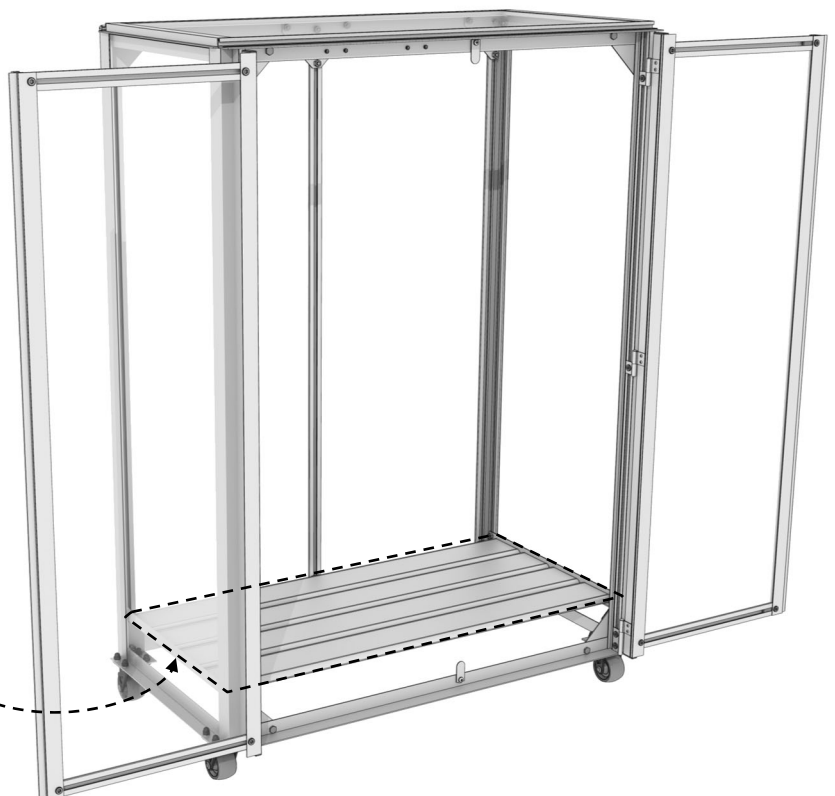

# Seed tray

Image				
Part Code	TRAY	8344	a2	a9
Length(mm)	n/a	710	M6	M6x10
Quantity	6	4	10	10

In a similar way to how you setup your staging horizontals you need to do the same for your seed tray rails '8344'. Again measure accurately the heights desired and use the twist-in crop head bolts to lock them into place. You can also use a mini-spirit level to ensure the front and rear rails are in alignment. Consider the height of the plants which are going to go into the trays when deciding on the rail heights so they have enough room to grow.

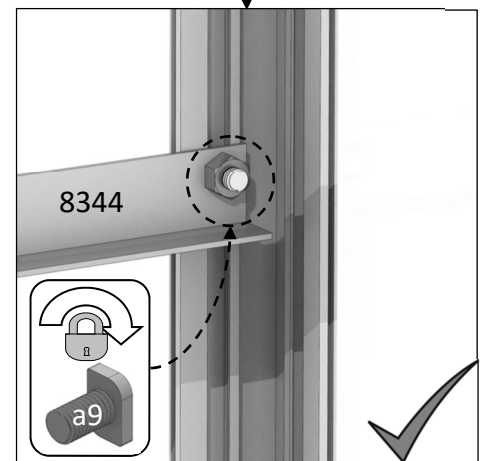
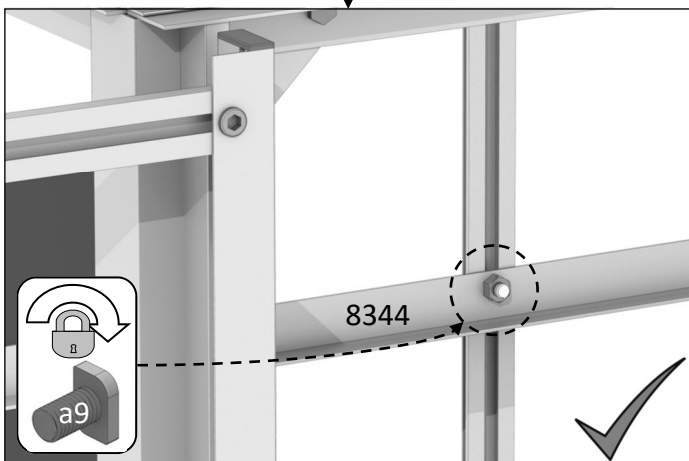
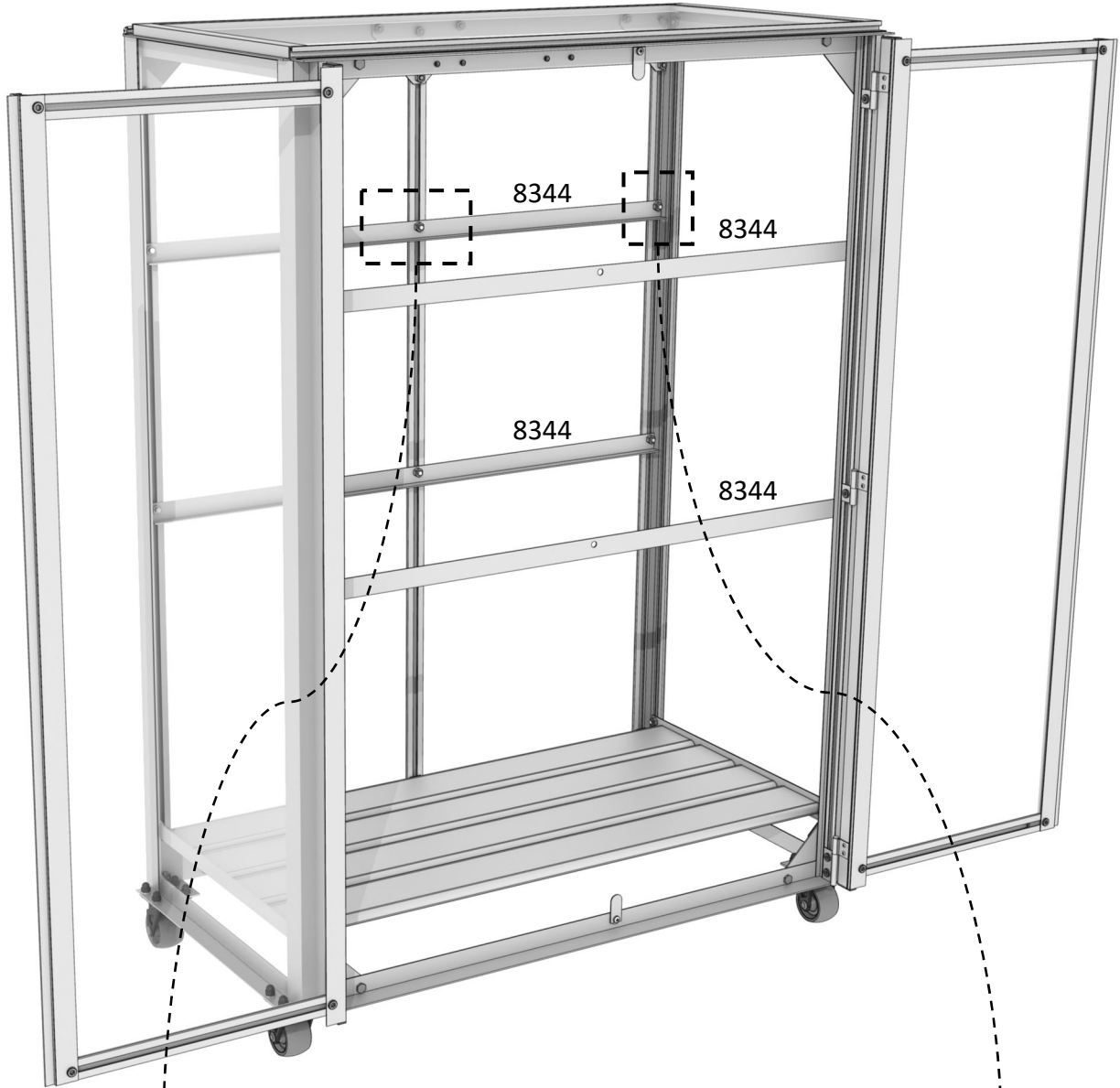

Now it is just a matter of dropping your six trays down between the seed tray rails and your Balcony greenhouse is complete ready for use.



If you spot any errors or have any constructive comments regarding this manual please email them to [info@greenhousepeople.co.uk](mailto:info@greenhousepeople.co.uk) .

Whilst the information contained in this booklet is accurate at the time of publication improvements through development and design might not be indicated. We point out this fact to avoid any infringements of the Trade Descriptions Act and also to advise that The Greenhouse People Ltd reserve the right to change specifications and materials without prior notice.